

Pre-Job or Tailgate Conference will be performed before this job begins.
COTTON ELECTRIC COOPERATIVE, INC.

STAKING SHEET

Completed By: ____
Date Complete: ____
Schedule #: ____

Acct #: 0
EQ LOC.: 08-49-5-22-L
Nearby EQ LOC.:
Phase:
Sub Sta.: Medicine Park
Feeder: Medicine Park East Top
Line Sect.: 5106
Co/code: Comanche

City Code:
School Dist.: 25
Board Dist.: 4 : Brian Demarcus
Coop Dist.: 05 : MEDICINE PARK
Service Loc.: 08-49-5-22-L
Legal: NE-14-3N-12W
Desc.: REPLACE PRIMARY UDG
Add Ser Loc.:
Add Ser Loc.:
Add Ser Loc.:

WORK ORDER NO: 56260
JOB NUMBER: LW-03-27-2019-1
NAME: WICHITA MNT ESTATES
SHEET NUMBER 1 OF 19
PHONE #:
740 C CODE: 608

STAKED: Larry Williams

Job Briefing

Hazards Associated w/ Job ____

Work Procedure ____

Special Procedures ____

Energy Source Control ____

P.P.E. ____

Foreman _____

Job Comments:

OKIE #: Can Begin: Time: Expires:
NO. OF MEMBERS: 30 / 30 PRIMARY LINE FT.: 256 / 7257 SEC ONLY FT.: 5243 / 2037 SERVICE DROPS FT.: 1830 / 26

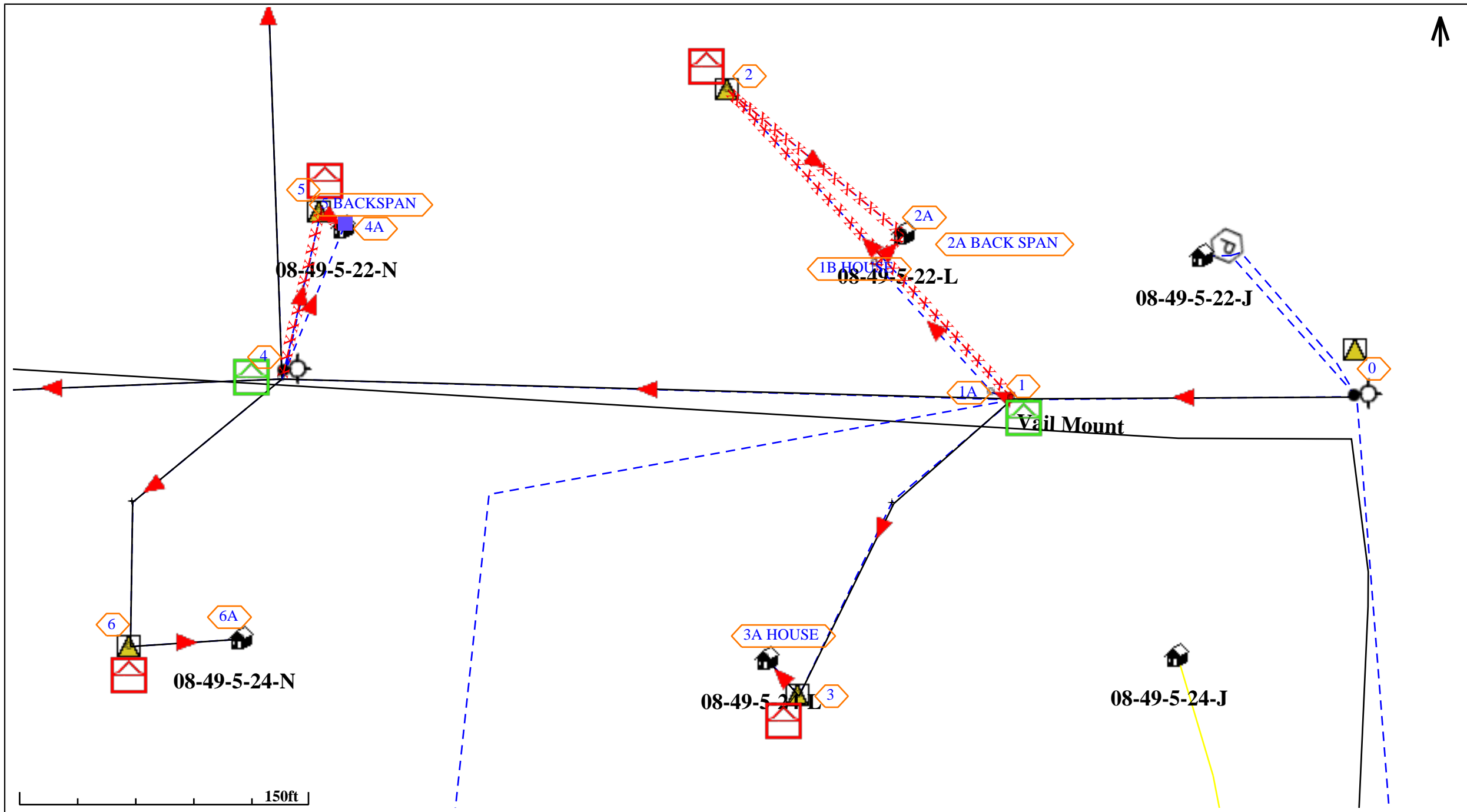

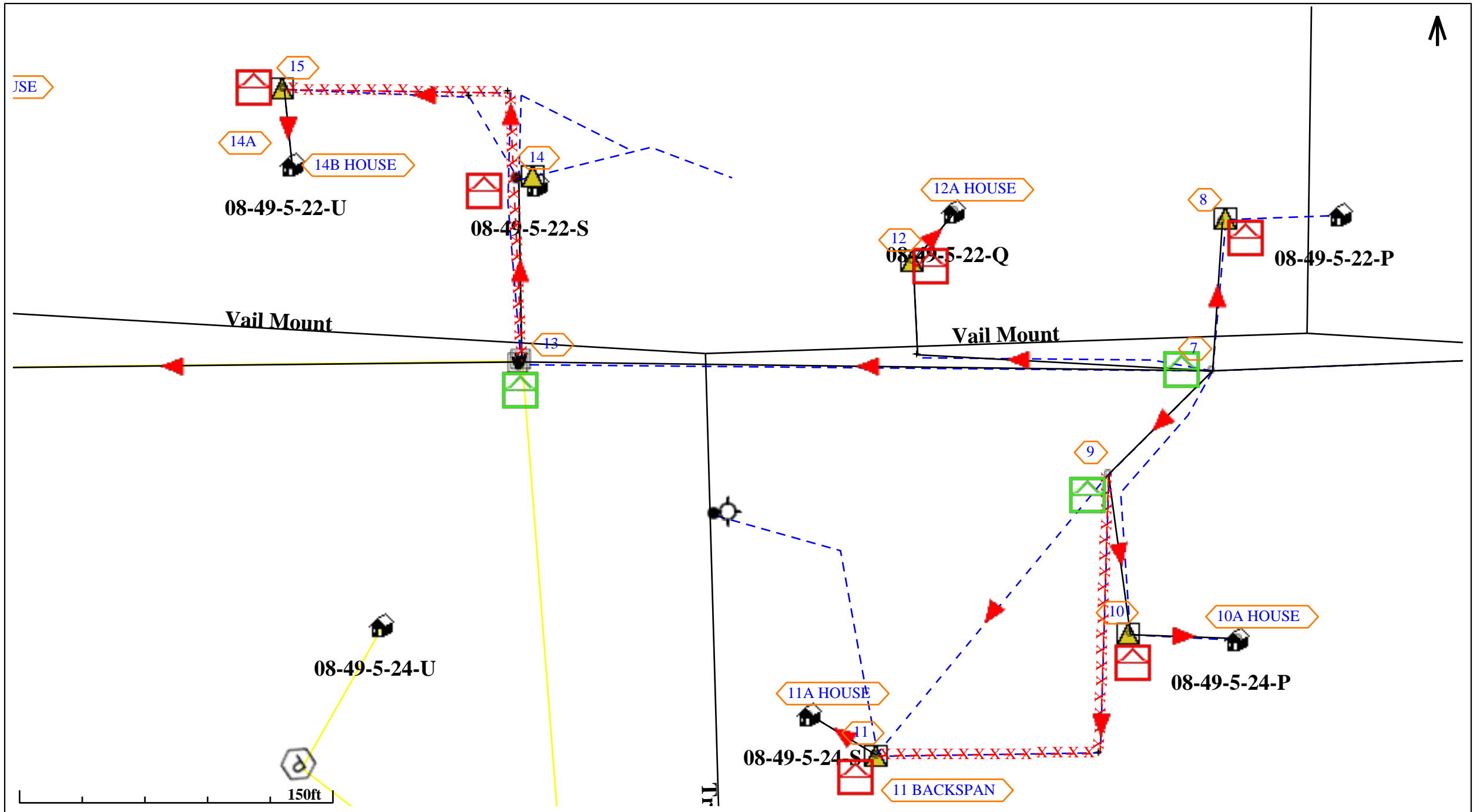

POLE NO	PRI (BACK) SPAN	POLE (H & C)	PRI UNIT	TRANS (UG)	GR. (H1.1)	PRIMARY PEDS (UM3))	TERMINATION (UA or UC)	SECT. ASSEMB (UM6-1)	MISC. UNITS	SEC WIRE	SERVICE WIRE	SEC. PEDS. (UMB)	METER SIZE	COMMENTS
15E SHOP					UH1.1					(5) 4/0 UFTP		UM8-200A	3W-15A	
16	(336) 1/0ALUDG (336) 1/0ALUDG			UVG7	UH1.1 UH1.1*	UM3-04*		(2) UM6-1 (2) UM6-1*						100 KVA STREET LIGHT WIRE
16A										(162) 350 UFTP		UK5		
16B											(75) 4/0 UFSV	UK5		
16C					UH1.1					(10) 4/0 UFTP (10) 4/0 UFTP*		UM8-200A	3W-15A	08-49-6-25-W
16D HOUSE					UH1.1					(56) 4/0 UFTP*	(56) 4/0 UFSV	UM8- PED-CT*	2W-5A*	
16F					UH1.1					(217) 4/0 UFTP		UM8-200A	3W-15A	08-49-6-25-V
16G HOUSE					UH1.1*					(26) 4/0 UFTP*	(26) 4/0 UFSV	UM8- PED-CT*	2W-5A*	
17	(190) 1/0ALUDG			UG7*	UH1.1*			UM6-1*						
18	(276) 1/0ALUDG			UVG7*	UH1.1*			UM6-1*						
19	(319) 1/0ALUDG			UG7*	UH1.1*			UM6-1*						
20	(220) 1/0ALUDG (220) 1/0ALUDG			UVG7	UH1.1 UH1.1*	UM3-04*		(2) UM6-1 (4) UM6-1*						50 KVA
20A HOUSE					UH1.1						(114) 4/0 UFSV	UM8- BASE-200A		
20B					UH1.1					(153) 4/0 UFTP		UM8-200A	3W-15A	08-49-6-25-T
20C HOUSE					UH1.1*					(61) 4/0 UFTP*	(61) 4/0 UFSV	UM8- PED-CT*	2W-5A*	
21	(130) 1/0ALUDG			UG7*	UH1.1*			UM6-1*						
22	(175) 1/0ALUDG			UVG7*	UH1.1*			UM6-1*						
23	(221) 1/0ALUDG			UVG7*	UH1.1*			UM6-1*						
24	(179) 1/0ALUDG (179) 1/0ALUDG			UVG7	UH1.1			(2) UM6-1						50 KVA
24A										(5) 4/0 UFTP		UK5		

POLE NO	PRI (BACK) SPAN	POLE (H & C)	PRI UNIT	TRANS (UG)	GR. (H1.1)	PRIMARY PEDS (UM3))	TERMINATION (UA or UC)	SECT. ASSEMB (UM6-1)	MISC. UNITS	SEC WIRE	SERVICE WIRE	SEC. PEDS. (UMB)	METER SIZE	COMMENTS
26	(152) 1/0ALUDG			UG7*	UH1.1*			UM6-1*		(152) 4/0 UFTP		UK5		
27	(234) 1/0ALUDG (234) 1/0ALUDG			UVG7	UH1.1 UH1.1*	UM3-04*		(3) UM6-1 (4) UM6-1*						100 KVA STREET LIGHT
27A										(119) 350 UFTP		UK5		
27B										(47) 4/0 UFTP		UK5		
27C					UH1.1					(52) 4/0 UFTP		UM8-200A	3W-15A	08-49-6-25-N
27D					UH1.1*					(162) 4/0 UFTP*	(162) 4/0 UFSV	UM8- PED-CT*	2W-5A*	
28	(79) 1/0ALUDG			UG7*	UH1.1*			(3) UM6-1*		(79) 4/0 UFTP		UK5		
28 BACKSPAN	(449) 1/0ALUDG (449) 1/0ALUDG													
29	(177) 1/0ALUDG			UG7*	UH1.1*			UM6-1*						
30	(186) 1/0ALUDG			UG7*	UH1.1*			UM6-1*						
31	(337) 1/0ALUDG (337) 1/0ALUDG			UVG7	UH1.1			(2) UM6-1						100 KVA
31A	(144) 1/0ALUDG			UG7*	UH1.1*			UM6-1*						
31A	(67) 1/0ALUDG			UG7*	UH1.1			UM6-1*		(67) 4/0 UFTP		UM8-200A	3W-15A	08-49-6-23-K
31A BACKSPAN										(110) 4/0 UFTP*				
31A HOUSE					UH1.1*					(43) 4/0 UFTP*	(43) 4/0 UFSV	UM8- PED-CT*	2W-5A*	
31B										(115) 350 UFTP		UK5		
31B	(95) 1/0ALUDG			UG7*	UH1.1			UM6-1*		(95) 4/0 UFTP		UM8-200A	3W-15A	08-49-6-23-M
31B HOUSE					UH1.1*					(49) 4/0 UFTP*	(49) 4/0 UFSV	UM8- PED-CT*	2W-5A*	
31C					UH1.1					(7) 4/0 UFTP		UM8-200A	3W-15A	08-49-6-25-J
31D HOUSE					UH1.1					(98) 4/0 UFTP		UM8- BASE-200A	3W-15A	

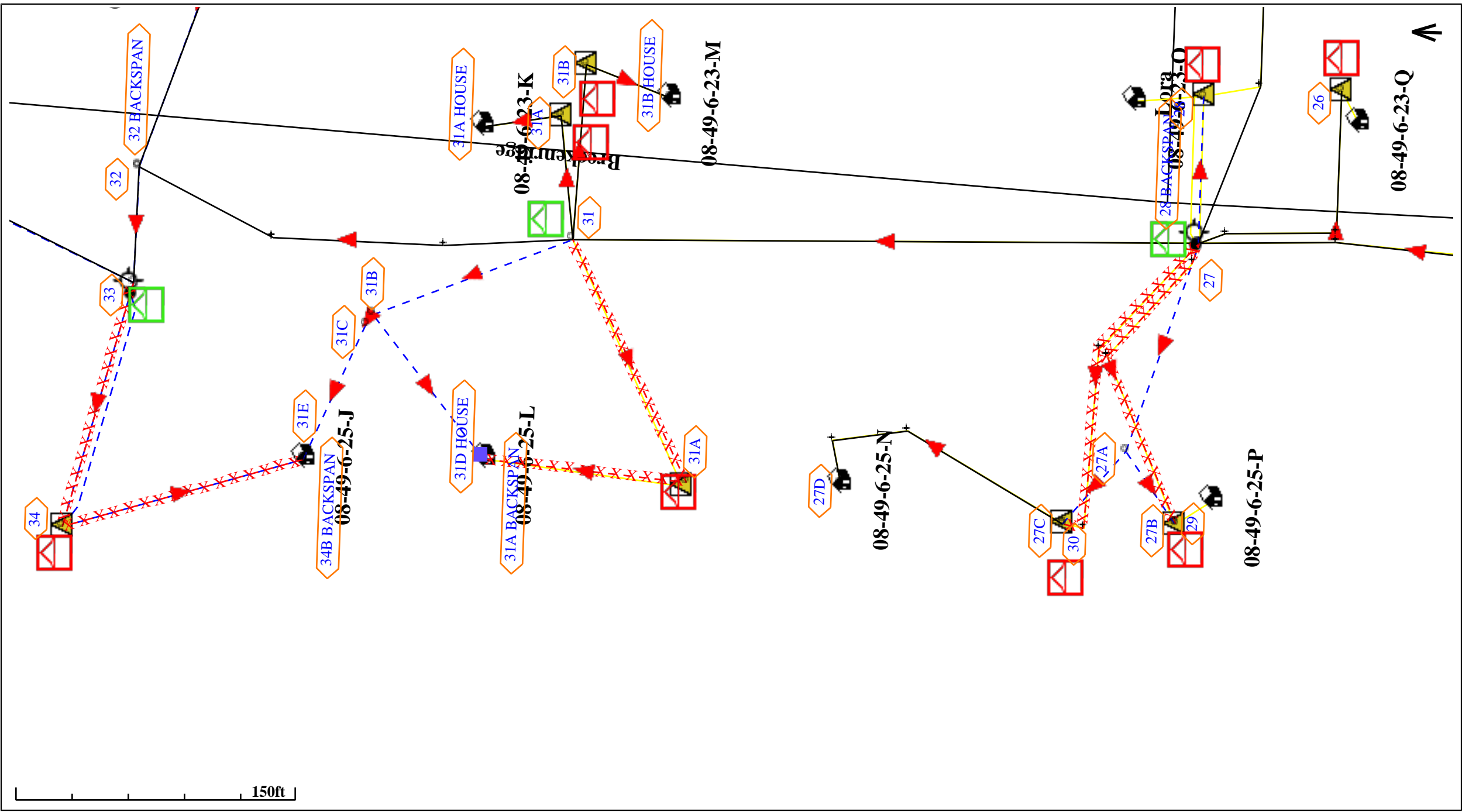

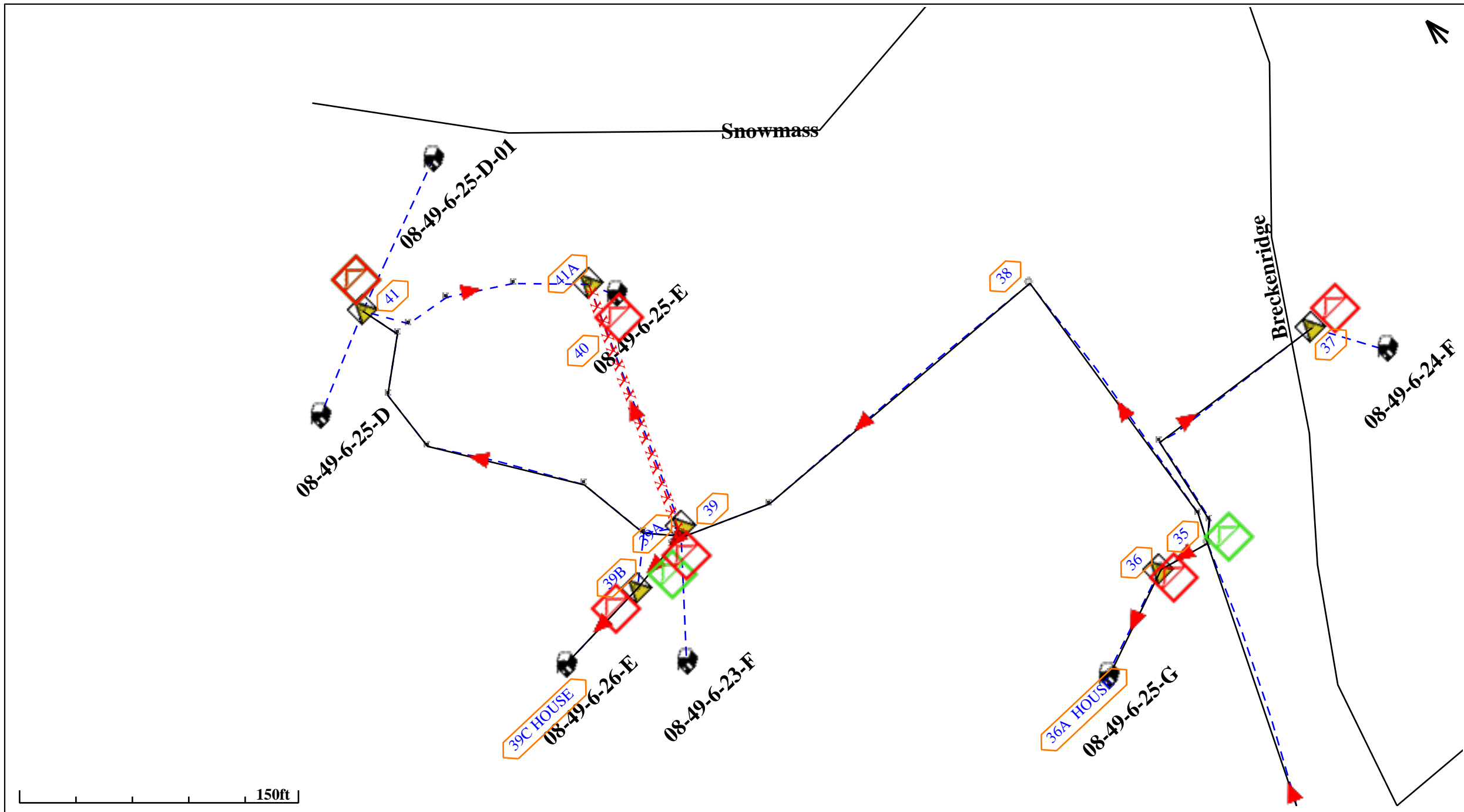

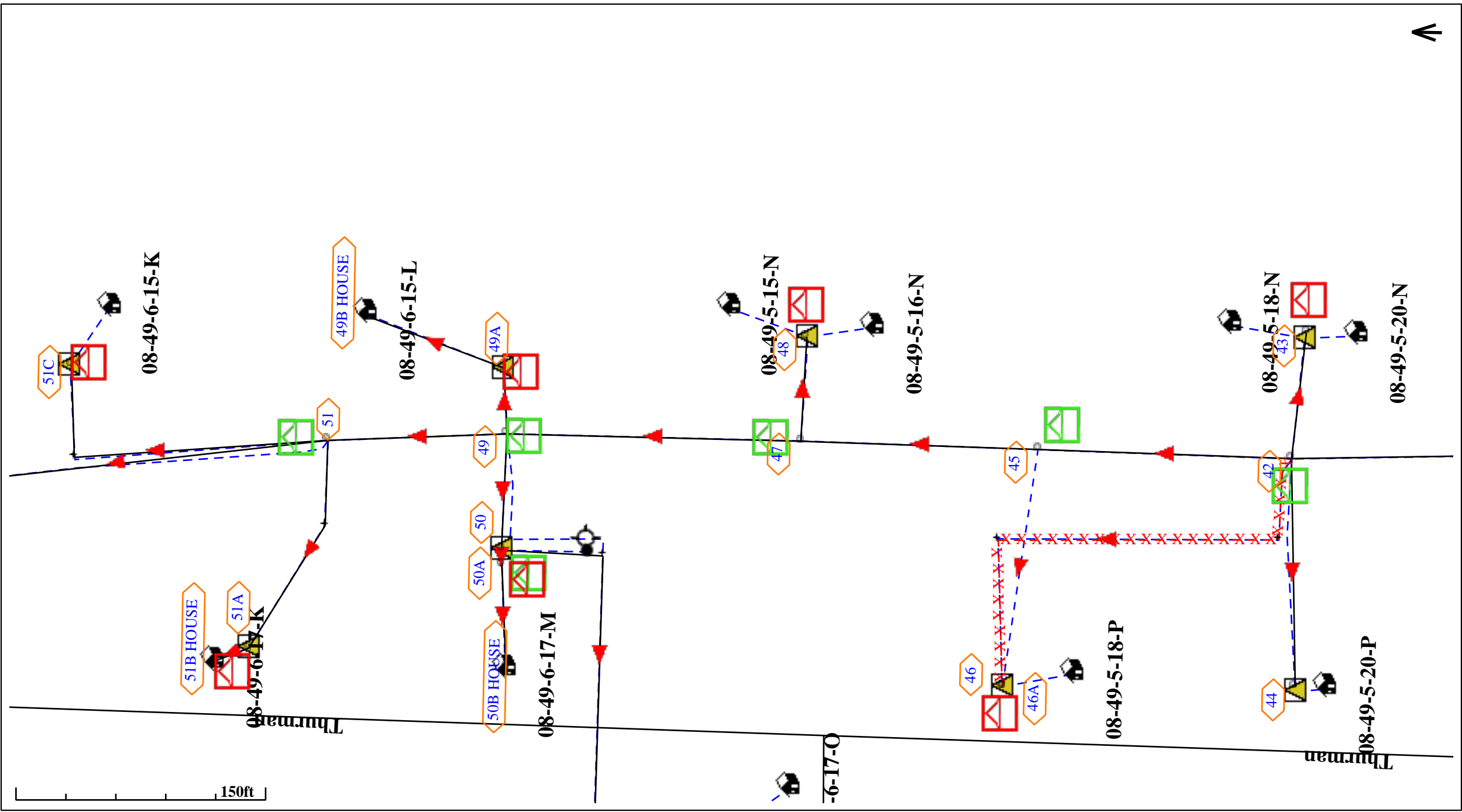

150ft



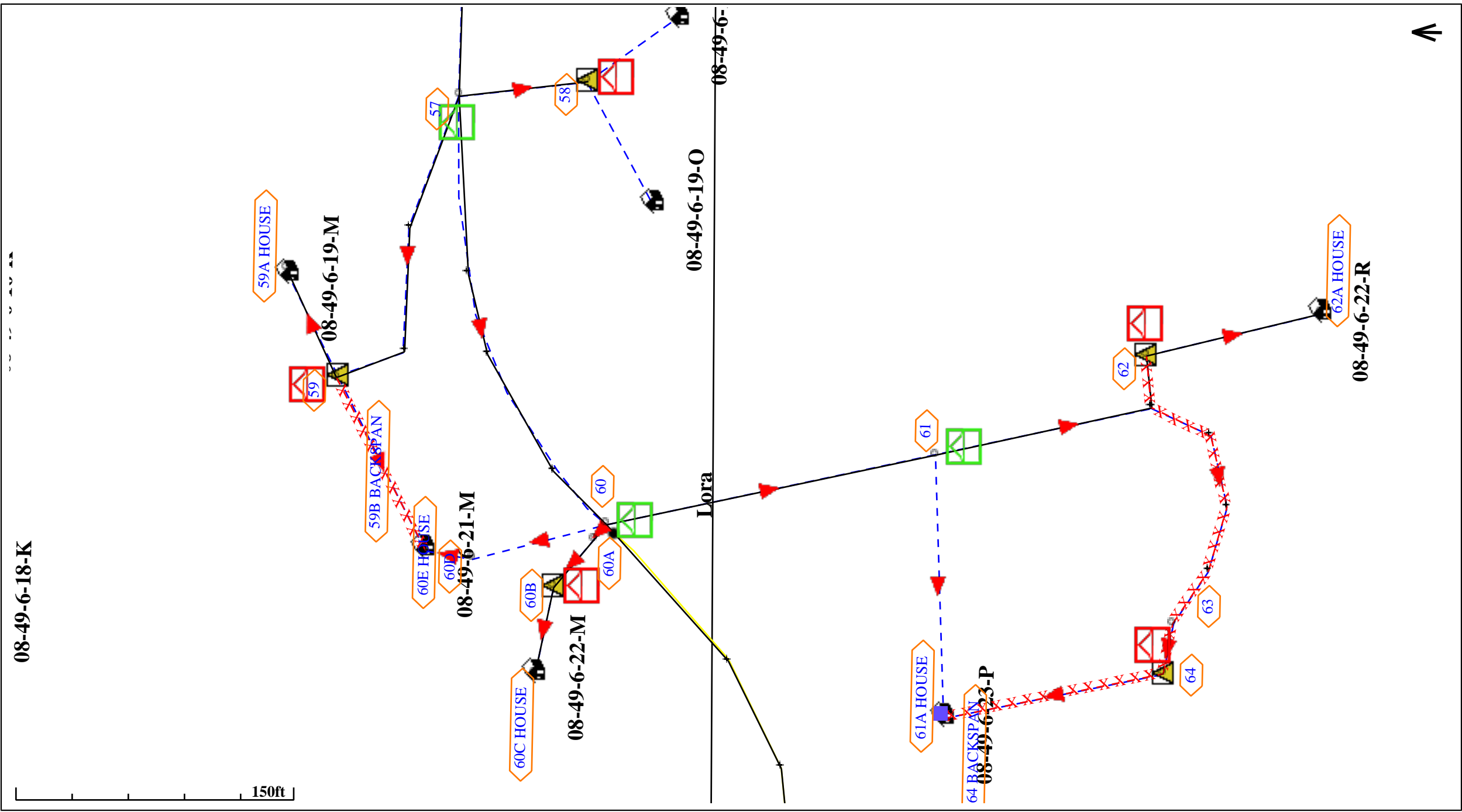

POLE NO	PRI (BACK) SPAN	POLE (H & C)	PRI UNIT	TRANS (UG)	GR. (H1.1)	PRIMARY PEDS (UM3))	TERMINATION (UA or UC)	SECT. ASSEMB (UM6-1)	MISC. UNITS	SEC WIRE	SERVICE WIRE	SEC. PEDS. (UMB)	METER SIZE	COMMENTS
52	(256) 1/0ALUDG (256) 1/0ALUDG			UVG7	UH1.1 UH1.1*	UM3-04*		(2) UM6-1 (3) UM6-1*						50 KVA
52A	(12) 1/0ALUDG			UG7*	UH1.1 UH1.1*			UM6-1*		(12) 4/0 UFTP		UM8-200A	3W-15A	08-49-6-15-I
52B HOUSE					UH1.1*					(52) 4/0 UFTP*	(52) 4/0 UFSV	UM8- PED-CT*	2W-5A*	
52C	(114) 1/0ALUDG			UVG7*	UH1.1*			UM6-1*		(114) 4/0 UFTP				
52D					UH1.1					(38) 4/0 UFTP (38) 4/0 UFTP*		UM8-200A	3W-15A	08-49-6-17-I
52E HOUSE					UH1.1*					(32) 4/0 UFTP*	(32) 4/0 UFSV	UM8- PED-CT*	2W-5A*	
53	(218) 1/0ALUDG (218) 1/0ALUDG			UVG7	UH1.1 UH1.1*	UM3-04*		(2) UM6-1 (4) UM6-1*						50 KVA
53A	(45) 1/0ALUDG			UG7*	UH1.1			UM6-1*		(45) 4/0 UFTP		UM8-200A	3W-15A	08-49-6-16-I
53B HOUSE					UH1.1*					(118) 4/0 UFTP*	(118) 4/0 UFSV	UM8- PED-CT*	2W-5A*	
53C	(88) 1/0ALUDG			UG7*	UH1.1*			UM6-1*		(88) 4/0 UFTP		UK5		
54	(276) 1/0ALUDG (276) 1/0ALUDG			UVG7	UH1.1 UH1.1*	UM3-04*		(2) UM6-1 (4) UM6-1*						75 KVA
54A	(54) 1/0ALUDG			UG7*	UH1.1			UM6-1*		(54) 4/0 UFTP		UM8-200A	3W-15A	08-49-6-18-I
54B HOUSE					UH1.1*					(49) 4/0 UFTP*	(49) 4/0 UFSV	UM8- PED-CT*	2W-5A*	
54C	(185) 1/0ALUDG			UG7*	UH1.1			UM6-1*		(185) 4/0 UFTP		UM8-200A	3W-15A	08-49-6-18-K
54D					UH1.1*					(48) 4/0 UFTP*	(48) 4/0 UFSV	UM8- PED-CT*	2W-5A*	
55	(168) 1/0ALUDG (168) 1/0ALUDG			UVG7	UH1.1			(2) UM6-1						50 KVA
55A										(94) 350 UFTP		UK5		
55B					UH1.1					(15) 4/0 UFTP		UM8-200A	3W-15A	08-49-6-21-I
55C HOUSE					UH1.1*					(55) 4/0 UFTP*	(55) 4/0 UFSV	UM8- PED-CT*	2W-5A*	
56	(171) 1/0ALUDG			UVG7*	UH1.1*			UM6-1*						

